

HINO

700 Series

FS 2848 AMT AIR 6267



6 x 4 Cab Chassis

* Illustration contains items not standard to the model

KEY FEATURES

Automated Manual Transmission (AMT) with Intarder
 Air Rear Suspension
 Jacob Type Engine Brake
 Heated & Electrically Operated External Mirrors
 Cruise Control
 ISRI 6860/870 Drivers Seat with Integrated Safety Belt
 Drivers SRS Airbag
 ECE R29 Cab Strength Compliance

KEY SPECIFICATIONS

GVM.	28,300kg
GCM.	72,000kg
Power	353kW
Torque	2,157Nm
Transmission	AMT ZF TraXon
Wheelbase	6,267mm
Nominal Body Length	9,180mm

ENGINE

Model		Hino E13C VG
Max. output (ISO NET) @ 1800 RPM		353kW (480 hp)
Max. torque (ISO NET) @ 1100 RPM		2,157Nm
Max. engine speed		1,900rpm
Engine compliance		ADR 80/03
Type	Diesel, turbo charged & inter-cooled, 6 cylinder in-line, overhead camshaft	
Combustion system	Direct injection type with Cooled-EGR	
Bore & stroke	137 x 146mm	
Piston displacement	12.913L	
Compression ratio	17.0:1	
Engine oil capacity	37.0L	
Fuel injection pump	Electronic control common rail	
Air cleaner	Dual paper elements	
Air compressor	Single cylinder, water cooled	
Bore & stroke	95 x 70mm	
Exhaust	Horizontal outlet	
Emission Control System	EGR & SCR (AdBlue®) meeting ADR 80/03 using Euro 5 STD	

CLUTCH

Automated Manual (AMT)	
Model	CS-430 Series
Type	Single plate with damper springs
Control	Automated & Auto adjusting
Facing material	Organic
Facing diameter	430mm

TRANSMISSION

Make and Model	ZF TraXon			
Code	ZF16 TX2441T0			
Type	16 forward and 2 reverse			
Control	Electronic			
Gear Ratios	1	14.680	12	1.780
	2	12.050	13	1.490
	3	9.920	14	1.220
	4	8.140	15	1.000
	5	6.780	16	0.820
	6	5.560	Rev 1	14.140
	7	4.570	Rev 2	11.600
	8	3.750		
	9	3.220		
	10	2.640		
	11	2.170		

PERFORMANCE

Calculation based on GCM with 11R22.5 drive tyres	72,000
Final drive ratio	3.9 to 1
Engine rpm @ 100km/h	1,668
Max theoretical speed (km/h)	114
All models electronically speed limited to 100km/h	
Gradeability Tan Θ (%) @ GCM	32.4

BRAKES

Type	Full air, dual circuit, “S” cam type, leading & trailing shoes for front & rear with auto slack adjuster	
Drum Size	Front	406.4 x 152mm
	Rear	410.4 x 216mm
Air drier	Equipped	
Anti-lock Brake System (ABS)	Equipped	
Trailer brake control	Hand control on dash (plumbing to end of chassis)	
Park brake	Spring brake acting on 1st and 2nd axles	
Engine brake	Engine compression brake equipped	
ZF Intarder transmission brake	Equipped	

AXLE, SUSPENSION & LOAD LIMITS

FRONT	Front Axle Model	MF 781 series
	Type	Reverse Elliot I-Beam
	Suspension	Semi-elliptic taper leaf springs with shock absorbers & stabiliser
	Spring Dimensions	1,700 x 90mm
	Number of Leafs	3
	Spring Rate	49.9 kgf/mm
	Axle Limit (including suspension)	7,500 kg
REAR	Tyre Limit	6,900 kg
	Rear Axle Model	THD 18 Tandem Axle
	Type	Bogie drive with inter-axle differential lock, fully floating single reduction by Hypoid gears
	Rear Rear Cross Lock	Fitted
	Models	HAS Air Rear
	Suspension	Hendrickson HAS 460 airbag with double acting shock absorbers
	Compliance	Road Friendly Suspension Rating N/o RF2005
	Axle Limit (including suspension)	21,000 kg
	Tyre Limit	21,800 kg

WHEELS & TYRES

Wheel type	10 stud disc wheels (ISO 335 PCD)
Rim size	22.5 x 8.25- offset 165mm
Tyre size	Front: 295/80R22.5 152/148
	Rear: 11R22.5-148/145
Number of tyres	11 (including spare)
Tools included	Wheelbrace and jack
Spare tyre carrier	Equipped

FUEL TANK

Type	Square aluminium
Volume	390L
Fuel pre-filter & sedimenter	Equipped
Locking fuel cap	Equipped
AdBlue® tank capacity	28L

CAB DETAILS

Type	Forward control, all steel welded construction, full-floating air-suspension cab with electrical tilting mechanism
Grill colour	Chrome
Driver SRS Airbag	Equipped
Seating capacity	3
Driver's seat	ISRI 6860/870 Urethane foam pads, high-back, lumbar support, Multi adjustable, air suspended, with integrated Safety Belt
Passenger seat	Urethane foam pads, high back & reclining seat with fabric cover
Centre seat	Equipped
Seat belts	3-point type on driver's & side passenger seats 2-point type for centre seat
External rear view mirrors	Electrical and heated, 2 flat type
	2 convex spotters and left side kerb view
Windshield wipers	Electric, triple-arm, with intermittent & 2 speed control
Sun visor and overhead console	Equipped
Centre overhead console	Equipped
Cigarette lighter (24 volt)	Equipped
Electrical converter	12V (harness type)
Ventilator	Forced type with 4 speed electric blower
Heater & defroster	Equipped
Air conditioner	Equipped
Sleeper berth	Single, with blackout curtains (ADR Compliant)
Multi media system	6.5" LCD, HD touch screen display with DAB+ AM/FM radio, AUX input, Bluetooth® 4.1, Android 6.0, CANBUS connection and Wi-Fi enabled
Speakers	Driver, passenger & centre
Floor mat	Vinyl mat
Front air spoiler	Equipped
Cab step	Equipped
Trim	Full trim type / side roof back
Electric power windows	Both sides
Electric door lock	Remote control keyless entry
Cab pockets	Both door sides & passenger seat
Cruise Control	Equipped
Reverse camera	Equipped

ELECTRICAL

Type	24 volts, negative earth
Batteries	12V x 2 series connection
Capacity	150Ah at 20 hour rate
Alternator	Brushless type 24V, 90A with built-in rectifier and voltage regulator
Starter	24V, 6.0kW
Lamps	Headlamps, fog lamps, cornering lamps, room lamp (fluorescent lamp), map lamp

STEERING

Steering column	Telescopic & tilt with locking device	
Steering box	Recirculating ball with Integral Power Steering	
Gear ratio	25.2:1	
Steering angle	Inside 49°	Outside 35°

POWER & TORQUE CHART (ISO NET) E13C-VG

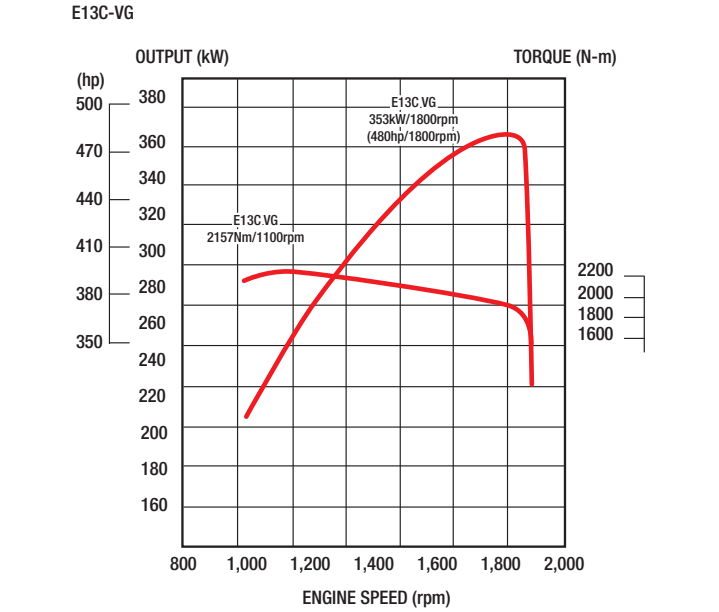

INSTRUMENTS

Meters and gauges	Warning, pilot lamps and buzzers
Speedometer with trip meter	Engine oil pressure warning lamp & buzzer
Odometer	Air pressure warning lamp & buzzer
Fuel gauge	High beam indicator lamp
Tachometer	Turn signal indicator lamp
Coolant temperature gauge	Parking brake indicator lamp
Air pressure gauge x 2	Coolant level warning lamp & buzzer
Switches	Differential lock indicator lamp
Lights	Engine over-run warning buzzer
Indicators & passing	Battery charging indicator lamp
Wiper & washer	Fuel filter water level warning lamp
Hazard lamp	ABS warning lamp
Fog lamp	Trailer brake indicator lamp
Room lamp	Others
Warning lamp check	One key starting-stopping
Map lamp	Horn button
Inter axle lock	Idle up control knob
Rear differential cross lock	Gear display
Mirror heating	
Economy running	
Engine brake	
Cruise Control	
Low speed (Slow)	

CHASSIS FRAME

	Air rear suspension
Type	Ladder-shaped channel section side rails
Chassis width (at rear)	840mm
Main section in mm (depth x flange x thickness)	300 x 90 x 8.0mm
Main section tensile strength	620 N/mm ²
Tow hook (front)	5,000 kg allowable load
Front underrun protection	Equipped

GENUINE ACCESSORY OPTIONS

Bull bar	Stoneguard
Chrome wheel covers	Woodgrain dash panel
Sat Nav	Transmission PTO
Extra vision cameras (up to 3)	DVR

Please check with your dealer for price, availability & fitment for these options

DIMENSIONS – MM/CAPACITIES

Model 700 Series	
Variant	FS 2848 AMT AIR 6267
Model code	FS1EVLG-VRA
Wheelbase (WB)	6,267
Nominal Body Length (WB x 0.6) + CA – 100 *Max overhang 3.7m	9,180
Overall length (OL)	10,895
Overall width (OW)	2,490
Overall height (OH)	3,000
Cab to rear axle centre (CA)	5,580
Front overhang (FOH)	1,380
Rear overhang (ROH)	3,247
Front chassis height (FCH)	995
Rear chassis height (RCH)	1,045
Road clearance (at diff. case) (RC)	210
Front track (FT)	2,050
Rear track (RT)	1,840
Turning circle (kerb to kerb)	21,800
Turning circle (wall to wall)	23,600
Chassis mass – kg (standard tools, 10 litres of fuel, spare tyre and subject to a ±3% variance)	
Total	8,655
Front	4,869
Rear	3,786
GVM	28,300
GCM	72,000

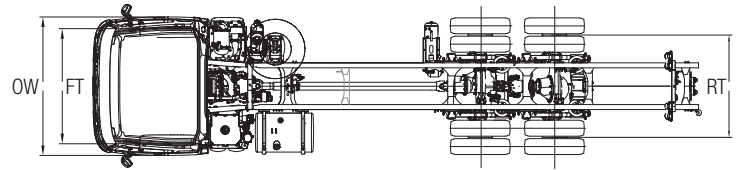
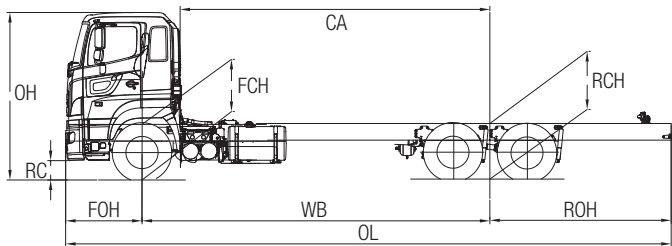

WARRANTY

New vehicle warranty period

Heavy Duty Model	Axle configuration	Standard warranty (whichever comes first)	Engine component warranty (whichever comes first)	Cab corrosion perforation
700 FS 2848	6 x 4	3 years or 500,000km	60 months or 750,000km	36 months

Battery warranty – 12 months from date of delivery

Genuine parts or accessories warranty – 3 years unlimited kilometres when fitted by an authorised Hino dealer *

* For conditions, refer to the Hino Parts & Service warranty brochure



DISCLAIMER

Important notice. Hino Trucks are distributed in Australia by Hino Motor Sales Australia Pty Ltd A.C.N. 064 989 724. All efforts have been made to ensure the information contained in this brochure was correct at time of printing or uploading. Hino Motor Sales Australia Pty Ltd reserves the right to alter any details of the specifications & equipment without notice. Hino in so far as it is permitted by law to do so, shall not be liable in any way as a result of any reliance placed by any person on anything contained in this brochure. You should therefore check with your authorised Hino dealer at the time of ordering your motor vehicle to ensure that colour, specifications, equipment, design features & options are available for the vehicle you are ordering. Please note that some options may only be available in combination with others. Authorised Hino dealers will on request provide up to date information on all accessories, design features, prices & availability.